



**KTZ-SERIES
DEWATERING PUMPS**

SPECIFICATIONS

■ FEATURES

1. Semi-open, high chrome iron impeller with ductile iron wear plate increases wear resistance when pumpage contains abrasive particles.
2. Double inside mechanical seals with silicon carbide faces, running in an oil filled chamber and further protected by a lip seal running against a replaceable, 420 stainless steel shaft sleeve and impeller hub provides for the most durable seal design available.
3. Highly efficient, continuous duty air filled, copper wound motor with class E or B insulation, minimizes the cost of operation.
4. Built in thermal & amperage sensing, protector prevents motor failure due to single phasing, overloading or accidental run - dry conditions.

5. Double shielded, permanently lubricated, high temperature C3 ball bearings rated for a B-10 life of 60,000 hours, extend operational life.
6. Top discharge, flow-thru design enables operation at low water levels for extended periods.

■ APPLICATIONS

1. Commercial, industrial wastewater and construction site drainage.
2. Effluent transfer.
3. Decorative waterfalls and fountains.
4. Raw water supply from rivers or lakes.

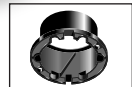

OIL LIFTER

■ SPECIFICATIONS

Discharge Size.....
 Horsepower Range.....
 Performance Range Capacity.....
 Head.....
 Maximum Water Temperature.....
 Materials of Construction
 Casing.....
 Impeller.....
 Shaft.....
 Motor Frame.....
 Fasteners.....
 Mechanical Seal.....
 Upper Seal.....
 Lower Seal.....
 Elastomers.....
 Impeller Type.....
 Solids Handling Capability.....
 Motor Nomenclature
 Type, Speed, Hz.....
 Voltage, Phase.....
 Insulation.....
 Bearings.....
 Accessories.....
 Operational Mode.....

■ STANDARD

2" ~ 6" Npt (50 ~ 150 mm)
 2 ~ 15 Hp. (1.5 ~ 11 kW)
 25 ~ 650 Gpm. (.09 ~ 2.46 m³/min)
 5 Ft. ~ 150 Ft. (1.5 ~ 45.7 m)
 104 °F. (40 °C.)
 Cast Iron
 High Chrome Iron Casting
 420 Stainless Steel
 Cast Iron
 304 Stainless Steel
 with Seal Pressure Relief Ports (10 ~ 15 HP)
 Silicon Carbide/Silicon Carbide (2 ~ 3 Hp.)
 Silicon Carbide/Carbon (5 ~ 15 Hp.)
 Silicon Carbide/Silicon Carbide
 NBR (Nitrile Rubber)
 Semi-open
 1/3" or 4/5" (8.5 or 20 mm)
 Air Filled, 3600 Rpm, 60 Hz.
 208/230/460/575 V., 3 Phase
 Class E, B (10 HP and 15 HP)
 Pre-lubricated, Double Shielded
 Submersible Power Cable 50' (15 m)
 Manual

■ OPTIONS

Length as Required
 Low Level Strainer