



**KRS - SERIES  
HIGH VOLUME - DEWATERING PUMP**

**SPECIFICATIONS**

**FEATURES**

1. Semi-open, Ductile Iron impeller with replaceable / adjustable wearplate increases wear resistance when pumpage contains abrasive particles.
2. Double inside mechanical seals with silicon carbide faces, (both top and bottom) running in an oil filled chamber and further protected by a lip seal running against a replaceable, 403 stainless steel shaft sleeve, provides for the most durable seal design available.
3. Highly efficient, continuous duty air filled, copper wound motor with class E, B and F insulation, minimizes the cost of operation.
4. Built in thermal & amperage sensing, protector prevents motor failure due to overloading or accidental run - dry conditions.

5. Double shielded, permanently lubricated, high temperature C3 ball bearings rated for a B-10 life of 60,000 hours, extend operational life.
6. Top discharge, flow-thru design enables operation at low water levels for extended periods.

**APPLICATIONS**

1. Commercial, industrial dewatering and construction site drainage.
2. Effluent transfer.
3. Decorative waterfalls and fountains.
4. Raw water supply from rivers or lakes.

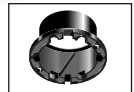

OIL LIFTER

**SPECIFICATIONS**

|                                 |   |
|---------------------------------|---|
| Discharge Size.....             | 3" ~ 14" Npt (80 ~ 350 mm)  |
| Horsepower Range.....           | 3 ~ 50 Hp. (2.2 ~ 37 kW)  |
| Performance Range Capacity..... | 100 ~ 4350 GPM (.37 ~ 16.5 m <sup>3</sup> /min)                   |
| Head.....                       | 8 Ft. ~ 100 Ft. (2.4 ~ 30.47 m)                                   |
| Maximum water temperature.....  | 104 °F. (40 °C.)  |
| Materials of Construction       |   |
| Casing.....                     | Cast Iron   |
| Impeller.....                   | Ductile Cast Iron or High Chrome Iron Casting (40 ~ 50 HP)        |
| Shaft.....                      | 420 Stainless Steel   |
| Motor Frame.....                | Cast Iron   |
| Fasteners.....                  | 304 Stainless Steel   |
| Mechanical Seal                 |   |
| Upper Seal.....                 | Silicon Carbide/Silicon Carbide                                   |
| Lower Seal.....                 | Silicon Carbide/Silicon Carbide                                   |
| Elastomers.....                 | NBR (Nitrile Rubber)  |
| Impeller Type.....              | Semi-open or Enclosed (KRS1022)                                   |
| Solids Handling Capability..... | 1/2" ~ 2" (12 ~ 50 mm)  |
| Bearings.....                   | Prelubricated, Double Shielded                                    |
| Motor Nomenclature              |   |
| Type, Speed, Hz.....            | Air Filled, 1800 Rpm, 60 Hz.                                      |
| Voltage, Phase.....             | 208/230/460/575 V., 3 Phase                                       |
| Insulation.....                 | Class E (3 ~ 7.5 Hp.),<br>B (10 ~ 15 Hp., KRS1022) and F (Others) |
| Accessories.....                | Submersible Power Cable 50' (15 m)                                |
| Operational Mode.....           | Manual  |

**STANDARD**

|                                 |   |
|---------------------------------|---|
| Discharge Size.....             | 3" ~ 14" Npt (80 ~ 350 mm)  |
| Horsepower Range.....           | 3 ~ 50 Hp. (2.2 ~ 37 kW)  |
| Performance Range Capacity..... | 100 ~ 4350 GPM (.37 ~ 16.5 m <sup>3</sup> /min)                   |
| Head.....                       | 8 Ft. ~ 100 Ft. (2.4 ~ 30.47 m)                                   |
| Maximum water temperature.....  | 104 °F. (40 °C.)  |
| Materials of Construction       |   |
| Casing.....                     | Cast Iron   |
| Impeller.....                   | Ductile Cast Iron or High Chrome Iron Casting (40 ~ 50 HP)        |
| Shaft.....                      | 420 Stainless Steel   |
| Motor Frame.....                | Cast Iron   |
| Fasteners.....                  | 304 Stainless Steel   |
| Mechanical Seal                 |   |
| Upper Seal.....                 | Silicon Carbide/Silicon Carbide                                   |
| Lower Seal.....                 | Silicon Carbide/Silicon Carbide                                   |
| Elastomers.....                 | NBR (Nitrile Rubber)  |
| Impeller Type.....              | Semi-open or Enclosed (KRS1022)                                   |
| Solids Handling Capability..... | 1/2" ~ 2" (12 ~ 50 mm)  |
| Bearings.....                   | Prelubricated, Double Shielded                                    |
| Motor Nomenclature              |   |
| Type, Speed, Hz.....            | Air Filled, 1800 Rpm, 60 Hz.                                      |
| Voltage, Phase.....             | 208/230/460/575 V., 3 Phase                                       |
| Insulation.....                 | Class E (3 ~ 7.5 Hp.),<br>B (10 ~ 15 Hp., KRS1022) and F (Others) |
| Accessories.....                | Submersible Power Cable 50' (15 m)                                |
| Operational Mode.....           | Manual  |

**OPTIONS**

|                                 |   |
|---------------------------------|---|
| Discharge Size.....             | 3" ~ 14" Npt (80 ~ 350 mm)  |
| Horsepower Range.....           | 3 ~ 50 Hp. (2.2 ~ 37 kW)  |
| Performance Range Capacity..... | 100 ~ 4350 GPM (.37 ~ 16.5 m <sup>3</sup> /min)                   |
| Head.....                       | 8 Ft. ~ 100 Ft. (2.4 ~ 30.47 m)                                   |
| Maximum water temperature.....  | 104 °F. (40 °C.)  |
| Materials of Construction       |   |
| Casing.....                     | Cast Iron   |
| Impeller.....                   | Ductile Cast Iron or High Chrome Iron Casting (40 ~ 50 HP)        |
| Shaft.....                      | 420 Stainless Steel   |
| Motor Frame.....                | Cast Iron   |
| Fasteners.....                  | 304 Stainless Steel   |
| Mechanical Seal                 |   |
| Upper Seal.....                 | Silicon Carbide/Silicon Carbide                                   |
| Lower Seal.....                 | Silicon Carbide/Silicon Carbide                                   |
| Elastomers.....                 | NBR (Nitrile Rubber)  |
| Impeller Type.....              | Semi-open or Enclosed (KRS1022)                                   |
| Solids Handling Capability..... | 1/2" ~ 2" (12 ~ 50 mm)  |
| Bearings.....                   | Prelubricated, Double Shielded                                    |
| Motor Nomenclature              |   |
| Type, Speed, Hz.....            | Air Filled, 1800 Rpm, 60 Hz.                                      |
| Voltage, Phase.....             | 208/230/460/575 V., 3 Phase                                       |
| Insulation.....                 | Class E (3 ~ 7.5 Hp.),<br>B (10 ~ 15 Hp., KRS1022) and F (Others) |
| Accessories.....                | Submersible Power Cable 50' (15 m)                                |
| Operational Mode.....           | Manual  |
|                                 | Length as Required  |